

assembly instructions

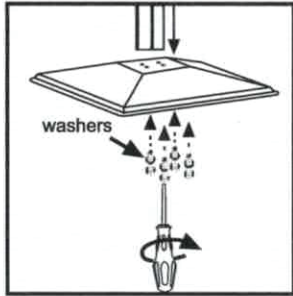

1) Screw the base to the pole

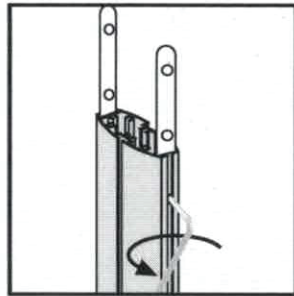

2) Use the Allen wrench to attach the rails that connect the posts together

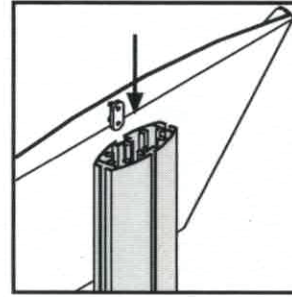

3) Slide the smaller rails (on the back side of the literature tray) down into the top of the lower pole's side channels

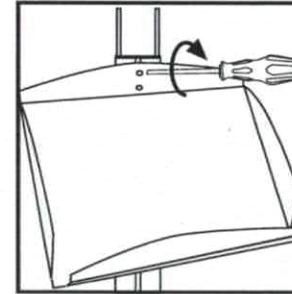

4) Tighten up the screws in the literature trays

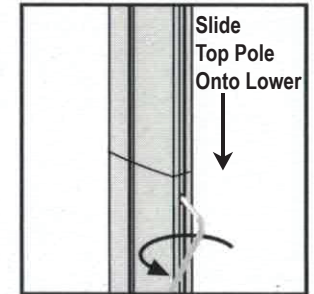

5) Slide the rails sticking out of the lower pole into the bottom of the upper pole. tighten

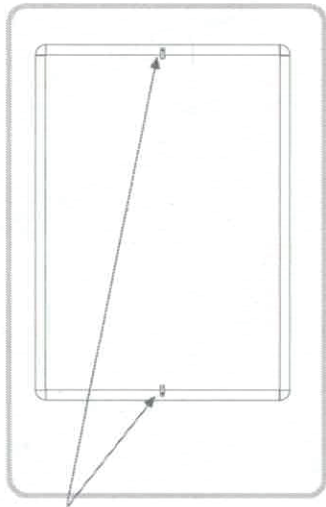

6) Slide the back connectors (on the back of the snap-frames) down into the side channel on the side of the top post.

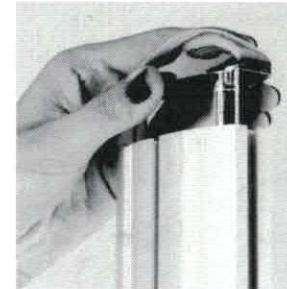
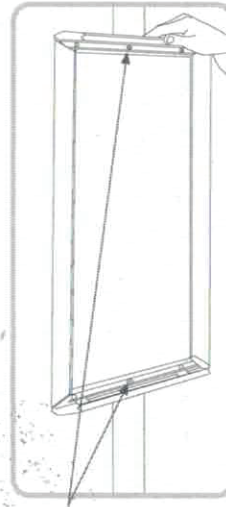
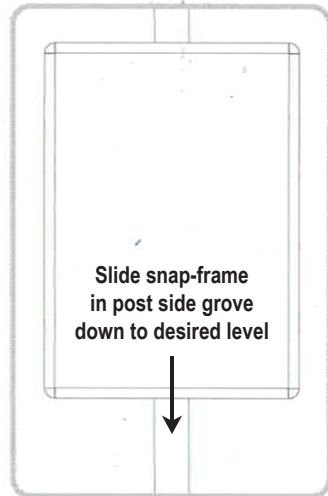

8) Put the cap on the pole and you're done.

